

# KENWEI

## ***10.2" COLOR TFT VIDEO DOOR PHONE INDOOR MONITOR***



- SA20C
- SA20C-W80
- SA20C-W200
- SA20C-PH
- SA20C-PH80
- SA20C-PH200

Top Way Intelligent Science & Technology Co., Ltd  
[http:// www.kenwei.com](http://www.kenwei.com)

CE FC UL CQC R&TTE RoHS  
ISO9001 ISO14000 OHSAS18001

*Products Introduction* . . . . . 4

*Feature and parts* . . . . . 5

*Menu operation* . . . . . 7

*Menu function* . . . . . 8

*Operation* . . . . . 19

*Special function* . . . . . 26

*Introduction for color image memory ( W80/PH80 )* . . . . . 28

*Operation for color image memory (W80/PH80)* . . . . . 29

*Introduction for color image memory ( W200 / PH200 )* . . . . . 31

*Operation for color image memory (W200/PH200)* . . . . . 33

*Instruction of voice status* . . . . . 35

*Instruction of light indicators* . . . . . 35

*Operation for OSD menu* . . . . . 36

*Troubles shooting guide* . . . . . 37

*Specifications* . . . . . 38

Thank you for purchasing our product of building intercom system series. Please read the instructions carefully and follow the directions before installing the products. Any problem of the products, please inquire your supplier.

**General features**

- 10.2"high-definition digital screen
- 16:9 widescreen design, enrich your vision
- Hands free full duplex talk
- Touch button
- Monitor and remote unlock
- Kinds of chord ring and DIY ring (optional)
- Color, brightness and contrast etc., adjustable
- 4 grade ring volume adjustable
- 0-100 grade talk volume adjustable
- No bother (mute) function
- W80, PH80 indicate the color image memory (optional)
- W200, PH200 indicate the color memory for both image and video, which been saved in SD card up to 16G.
- Intercom and call transfer between indoor monitors (support max. to 4 monitors)
- 4 way CCTV cameras connectable
- Video signal output
- Message function (optional)
- Voice and video record function (optional)
- Extension switch for multi-function (optional)
- Extension ring output (optional)
- Pedal control and 2<sup>nd</sup> door calling function (optional)
- Remote control by telephone (optional)



**CAUTION:** To avoid the risk of electric shock, please don't remove cover or back. Please ask professional person if maintenance needed.



Remind users that important operation and maintenance guide are included in the attached user's manual.

\* KENWEI reserves the right to change or modify design, features functions and specifications without any prior notice for the improvement and promotion of products' quality. Please refer to the real products.

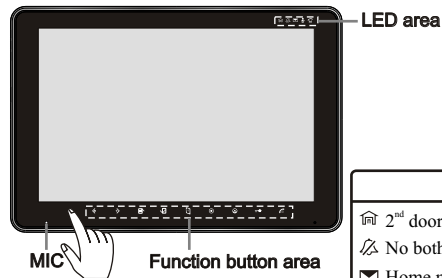

LED area	Function button area
🏠 2 <sup>nd</sup> door calling LED	⚙️ Menu button / Shift button / Away LED
🚫 No bother LED	⬅️ Left
✉️ Home message LED	➡️ Right
🎤 Message record / play LED	⬆️ Up
☎️ on telephone / telephone calling LED	⬇️ Down
	📁 Extension switch
	👤 Intercom
	📹 Monitor outdoor / CCTV camera
	🔑 Unlock
	🗣️ Talk / Stop

**Remark**

1. During operation, please touch the center of buttons as the picture shows.
2. To avoid operation invalid, don't wear anything in your hand, such as glove.

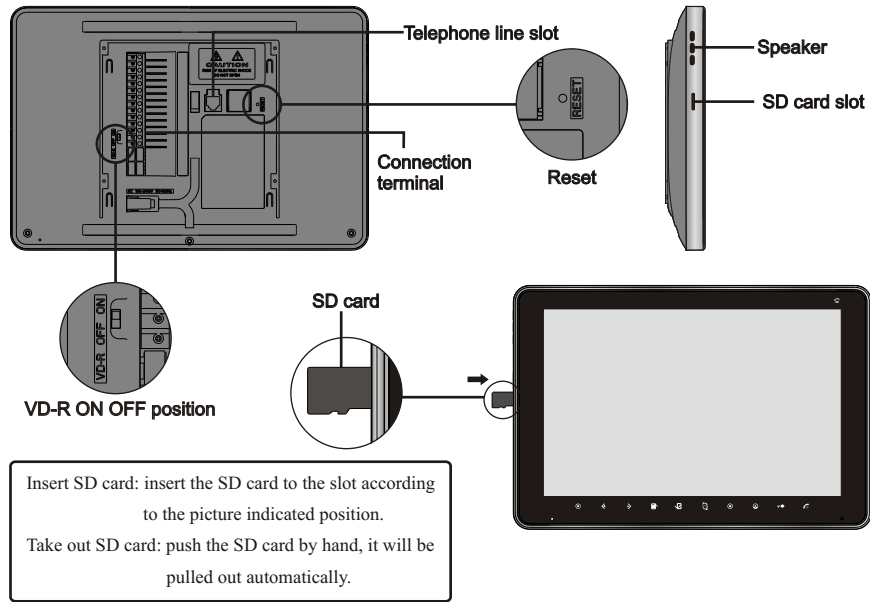

**Menu operation:**

1. Enter into the main menu: Hold “⚙️” till the unit sound DI
2. Exit the main menu: Touch “⚙️” or “⏪”
3. Select the item: Touch “⏴” or “⏵”
4. From main menu to sub menu: Touch “➡️”
5. From sub menu return to main menu: Touch “⚙️”
6. Exit the sub menu: Touch “⏪”
7. Function setup: Touch “➡️”

## MUSIC SET

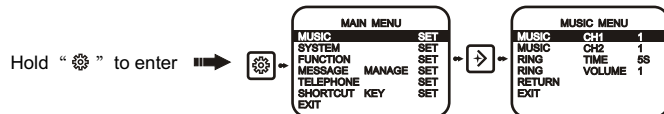

➤ **MUSIC CH1 / CH2 (12 chord rings for option)**

The 12<sup>th</sup> one is the DIY music, this function is available for W200 / PH200 only

➤ **RING TIME (5S, 10S, 15S, 20S for option)**

➤ **RING VOLUME (1, 2, 3, 4 grade for option)**

1 is the min. sound, 4 is the loudest sound

## SYSTEM SET

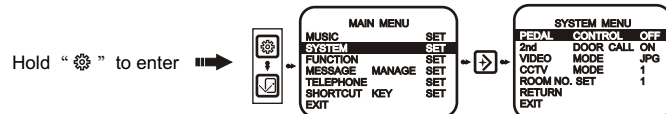

➤ **PEDAL CONTROL FOR TALK (Turn on / off)**

➤ **2<sup>nd</sup> DOOR CALLING (Turn on / off)** → **Optional**

The 2<sup>nd</sup> door calling is default to turn on

When the screen is off, if the 2<sup>nd</sup> door calls in, the indoor unit will sound the ring and “🔔” LED flashes about 8s to turn off

When the screen is on, if the 2<sup>nd</sup> door calls in, the “🔔” LED flashes about 8s to turn off

➤ **VIDEO MODE ( JPG / AVI)**

JPG: for W80 / PH80 & W200 / PH200

AVI: for W200 / PH200 only

➤ **CCTV MODE ( Mode 1 / Mode 2)**

Mode 1: All the indoor units could monitor their own connecting CCTV Camera.

Mode 2: All the indoor units could monitor the CCTV Camera which connected to the main indoor unit, which means just need to connect the CCTV camera on the main unit, it is unnecessary connect to the sub units

**Attention:** If the system has more than 1pc indoor unit, this function should be set on the main indoor unit.

➤ **Room No. set (1, 2, 3, 4 for option)**

**Attention:** When the system has more than 1pc indoor unit, the SYSTEM SET is available on the main unit only, if the operation is on sub unit, the screen will show “please set up on the main unit”.

## FUNCTION SET

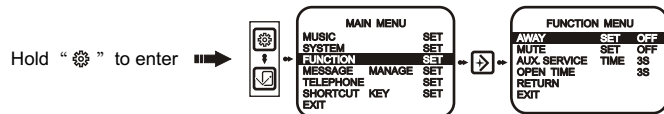

➤ **Away set (Turn on / off)**

Turn on: The unit sound “DI” and the “⚙️” LED turns on

Turn off: The unit sound “DI DI” and the “⚙️” LED turns off

➤ **Mute set—No bother setup (Turn on / off)**

Turn on: The “🔇” LED turns on

Turn off: The “🔇” LED turns off

➤ **Aux.service time—Extension switch time setup (3S, 10S, 20S, 30S for option)**

The system is default to 3S

➤ **OPEN TIME — Unlock time setup (1S, 3S, 5S, 10S for option)**

## MESSAGE MANAGE SET I

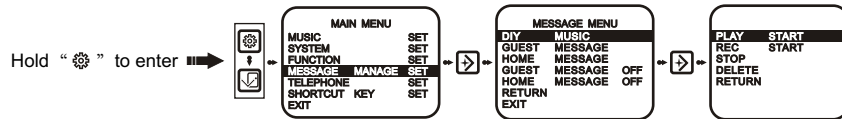

➤ **DIY MUSIC (Record, Play, Stop, Delete)**

**Attention:** a. The input music should be close to the MIC position during recording  
b. Recording time is about 12S.

➤ **GUEST MESSAGE—Leave the message for visitors (Record, Play, Stop, Delete )**

**Attention:** The recording time is about 12S.

➤ **HOME MESSAGE—Leave the message for family members (Record, Play, Stop, Delete )**

**Attention:** The recording time is about 35S.

Start recording: the unit sound DI and the “✉️” LED turns to red.

Finish recording: the unit sound DI DI and the “✉️” LED turns off.

Start playing: the “🎤” LED turns to blue.

Finish playing: the “🎤” LED turns off.

Delete the recorded music / message: if the unit is on playing, should be STOP playing first and then to delete.

**Attention: Message manage function is available on W200 / PH200 only**

## MESSAGE MANAGE SET II

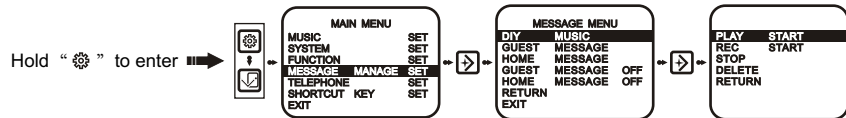

► **GUEST MESSAGE (ON / OFF)**

Turn on: If the “Away” and “Guest message” function is turned on, when the visitor calls in, after ringing (suggest to set the ring time to 5S), the visitor will hear the message which you recorded. This function is available on the main indoor unit only if the system has more indoor units.

Friendly reminder: If you purchase PH200, you can leave the message to visitors to remind them that the call will transfer to your phone after short waiting.

► **HOME MESSAGE (ON / OFF)**

Turn on: The “✉️” LED turns on (reminding), when the people be back home, they could check the message which you recorded (manually play).

**Attention:** Message manage function is available on W200 / PH200 only

## TELEPHONE SET I

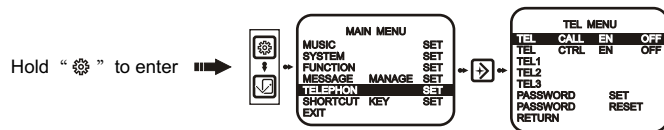

**Attention:** From main menu → telephone set, it needs to take about 1~2s to read the date (screen off)

► **TEL CALL EN OFF—Transfer the call from outdoor unit to the telephone (TEL1, TEL 2, TEL 3, OFF for option)**

Choose the phone which you want to connected from the listed (TEL 1, TEL 2, TEL 3) or if this function is unnecessary, you can choose OFF to turn off this function.

**Attention:**

- If the function is turned on, when outdoor unit calls in and nobody answer it, the call will transfer to your phone after 30S' ringing. The talking time between outdoor unit and your phone is 3 minutes.
- The connected telephone line should with CID which with FSK standard, otherwise the telephone could not be connected.
- During the outdoor unit talking with the telephone, indoor unit could switch the talk to outdoor unit by touching “📞” .
- The unit will sound “DI DI” on every 1 minute during the outdoor unit talking with the telephone (the max. talking time is 3 minutes).

## TELEPHONE SET II

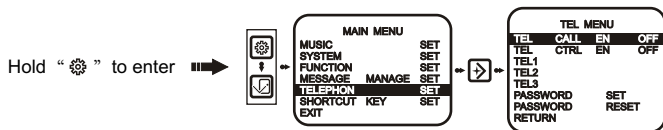

➤ **TEL CTRL EN OFF— Transfer the telephone call to the indoor unit while no one to answer the telephone after 7 times ringing ( ANY, LIST, OFF.)**

ANY: after 7 times ringing, the indoor unit will answer it and need to input the correct administration password to remote control the indoor unit.

LIST (TEL 1, TEL 2, TEL 3): after 7 times ringing, the indoor unit will answer it and no need to input the administration password to remote control

the indoor unit.

OFF: to turn off this function.

- **TEL1—input the phone number which you wish connected when you are not at home**
- **TEL2— input the phone number which you wish connected when you are not at home**
- **TEL3- —input the phone number which you wish connected when you are not at home.**  
(TEL 1, TEL 2, TEL 3 means you could input three different telephone number that you wish)

## TELEPHONE SET III

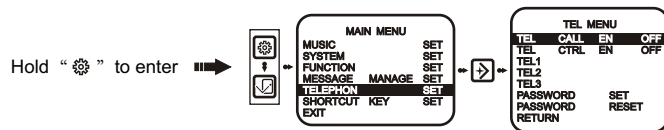

Phone number input method (The input number in 12 digits at max. ):

By touching “⏪” or “⏩” to choose the number and touch “⏹” to confirm the chose number, when all the number have been chose and correct, to choose “⏪” & “⏹” to confirm.

Phone number deleted method:

By touching “⏪” or “⏩” & “⏹” to delete.

➤ **PASSWORD SET (Administration and unlock password setup)**

Administration password (4 digits): The default password is 8888, if you want to change it, the input method like the phone number input

Unlock password (3 digits): The default password is 888, if you want to change it, the input method like the phone number input.

**Attention:** The password display is use \*\*\*\* to instead of exact number, the exact number will be displayed while you change the password.

- **PASSWORD RESET —After resetting, the Unlock & Administration password will be back to the defaulted one.**

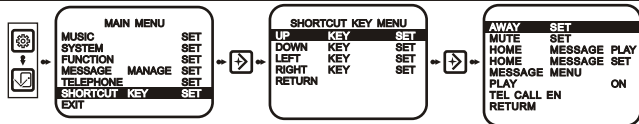

## TELEPHONE SET IV

**Password and control code for telephone's calling:**

When the telephone calls in, after hearing the "Du", then you could input the password to control the indoor unit. The unit will sound "Du" after inputting the correct password or control code (play home message without "Du" reminding).

Administration password "\*----#",

Unlock password "\*----#" , (The unit should under talking or monitoring mode)

\*08# listening to door 1

\*09# listening to door 2

\*07# talk to door 1

\*20# talk to door 2

**Available for W200/PH200 only**

\*10# setup the home message

\*12# listening the home message

\*13# turn on home message

\*14# exit the home message

\*15# turn on no bother mode

\*16# exit the no bother mode

\*17# turn on AWAY mode

\*18# exit the AWAY mode

\*86# hang up

**Attention:**

1. Telephone set is available on the main indoor unit only when the system has more than 1pc indoor unit. If the main and sub units are both equip with telephone function, the screen will display "please set up on the main unit" and if the sub unit doesn't equip with telephone function, the screen will display "No such function" when you try to setup on the sub unit(s).
2. If the TEL CALL EN and TEL CTRL EN are set to OFF, the telephone function and the "☎" will be turned off.
3. If the unit sounds "DI" for 6 times and the "☎" keeps flashing which means that the telephone line is not connected well.

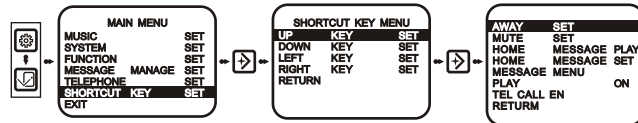
**SHORTCUT KEY SET**—Set the function which you wish to enter quickly on "☎", "⏴", "⏵", "⏪", "⏩"

UP KEY SET---- "☎"  
 DOWN KEY SET ---- "⏴"  
 LEFT KEY SET---- "⏵"  
 RIGHT KEY SET---- "⏪"

**To choose the below functions to enter quickly**

AWAY SET  
 MUTE SET (No bother setup)  
 HOME MESSAGE PLAY  
 HOME MESSAGE SET (Turn on / off)  
 MESSAGE MENU (Enter into message manage interface)  
 PLAY (Enter into video menu)  
 TEL CALL EN---Outdoor call transfer to telephone (turn on / turn off)

**Attention:**

- a. If the above function which you plan to setup to shortcut key, but the unit which you purchased doesn't equip with it, the screen will display "No such function"
- b. The functions which you set with shortcut key, should hold the "☎", "⏴", "⏵", "⏪", "⏩" till the unit sound "DI" to enter into, hold it again till the unit sound "DI DI" to exit.
- c. After initialization, the system default to:  
 "⏴": Away "☎": Mute (No bother)  
 "⏩": memory review (available for the model with image memory function)

## Monitor channel interface (Hold “☉” to enter)



MONITOR	CHANNEL	1
CCTV	CHANNEL	1
MONITOR	CH1	ON
MONITOR	CH2	OFF
MONITOR	CCTV1	OFF
MONITOR	CCTV2	ON
MONITOR	CCTV3	ON
MONITOR	CCTV4	ON

Monitor channel---Switch between CH1 / CH2

CCTV channel---Switch between CCTV1 / CCTV 2 / CCTV 3 / CCTV4

Monitor CH 1 ----To turn on / off monitoring

Monitor CH 2----- To turn on / off monitoring

Monitor CCTV 1---- To turn on / off monitoring

Monitor CCTV 2---- To turn on / off monitoring

Monitor CCTV 3--- To turn on / off monitoring

Monitor CCTV 4---- To turn on / off monitoring

The default set is “ON”.



If turn “OFF” the CH2 or CCTV1, the monitor image will turn to the next CCTV2 automatically.



## 1. ON/OFF

a. After connecting the power, the unit will enter into standby mode automatically, then all buttons' backlight turn on.(Buttons' backlight will be off automatically after 1s and power LED light on .)

Under Off mode, touch “☉” button (pic.1) , it will sound DI, means the unit is turning on and under standby mode, power LED on.

b. Under standby mode, touch and hold “☉” , till it sounds DI DI , all buttons' backlight turn off, means the unit enter into OFF mode.

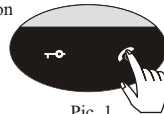

Pic. 1

## 2. Call reminding

When outdoor camera calls in, indoor monitor's screen will display its image automatically, and power LED flash, meanwhile sound the ring.

## 3. Talk/Stop

## a. Talk (when outdoor camera calls in)

Touch “☉” button (pic.1) to enter into talk mode, outdoor unit can talk with indoor monitor.

## b. Monitor to talk

Under monitor mode, touch “☉” button (pic.1) to enter into talk mode, indoor monitor can talk with the monitored outdoor unit.

## c. Standby to talk (Between indoor monitor and Door1)

Under standby mode, touch “☉” button (pic.1) to talk with Door 1.

**d. Stop**

Under talk mode, touch “☎” button (pic.1) to stop talk and back to standby mode.

Or wait 90s, it will automatically stop.

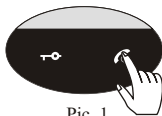

Pic. 1

**4. Unlock**

a. Under talk mode, touch “☎” button (pic.2) to open the door. Under monitor mode, the door could not be opened. (To reach the unlock function, the outdoor camera should be equipped with electronic lock.)

b. Unlock pulse time is what you set on Main menu → Function set → Open time (1S, 3S, 5S, 10S). If the “☎” button is holding all the time, the max. opening time is 10S.

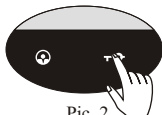
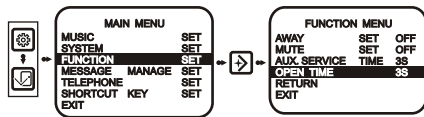

Pic. 2

**5. Monitor outdoor units and CCTV Cameras**

**a. 1pc indoor unit only**

“⊕” (pic.3): Under standby mode, 1<sup>st</sup> touch for CH 1, 2<sup>nd</sup> touch for CH 2, 3<sup>rd</sup> touch for CCTV 1, 4<sup>th</sup> touch for CCTV 2, 5<sup>th</sup> touch for CCTV 3, 6<sup>th</sup> touch for CCTV 4, 7<sup>th</sup> touch to exit. (All monitor channels have turned on).

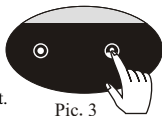

Pic. 3

**b. more than 1pc indoor unit**

If the CCTV mode is set to mode 1 on the main unit (Main menu---System set---CCTV mode) and all the monitor channels have turned on, the operation to monitor the outdoor units and CCTV cameras is the same as point a, but if one of indoor unit is on monitoring the CH1 / CH2, the others could monitor the CCTV camera which connected to their owns only and if the CCTV mode is set to mode 2 on the main unit, one of indoor unit is on monitoring, others could not be monitored both to outdoor cameras as well as to the CCTV Cameras.

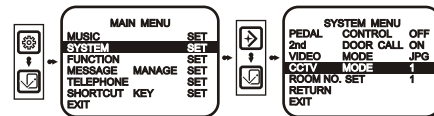

**6. Extension ring (Extra speaker)**

When outdoor unit calls in, the indoor unit and extension ring will ringing at the same time if the indoor unit has connected with extension ring.

When the main indoor unit wants to transfer the call to sub unit, the sub unit and extension ring will ringing at the same time if the sub unit has connected with extension ring.

## Operation

### 7. Intercom function (more than 1pc indoor unit)

- 2pcs indoor units connected: Under standby mode, touch and hold “⊙” button (pic.4) till the unit sound DI and the screen will display another indoor unit’s room number, then touch “☎” (pic.1) to call it.
- more than 2pcs indoor units connected: Under standby mode, touch and hold “⊙” button (pic.1) till the unit sound DI and the screen will display the relevant indoor unit’s room number, and you can by touching “⊙” (pic.1) to choose the room number which you want to call, then touch “☎” (pic.1) to call it.



Pic. 4

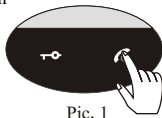

Pic. 1



Pic. 5

#### Attention:

- The each step of intercom operation should be within 10s, the screen will be turned off after 10s.
  - To exit the intercom operation by touching “⚙️” (pic.5)
  - If the room number doesn't exist or the call is failed, the screen will display “CONNECTION FAILED” .
- During calling, the “☎” (pic.1) will flash, when answered, the screen will be turned on and the screen will display “INTERCOM” , then you could talk with each other.
  - During calling, by touching and holding “☎” (pic.1) for 2s to stop.

### 8. Call transfer (suitable for more monitor)

When outdoor camera calls in, monitor A touch “☎” (pic.1) to start talking. If you need transfer this call to monitor B, operation method is same as intercom. After successful transferring, only monitor B will sound ring, others will get into busy mode. (For example, you need transfer the call to No. 3 monitor, touch “⊙” (pic.4), when the screen display “3” , touch “☎” (pic.1) to transfer to No. 3 monitor.)

### 9. Busy mode (suitable for more indoor units)

- When one of monitor is under monitoring or talking mode, others will be in busy mode
- When two monitors are on talking, others will be in busy mode, After finishing talking, all the monitors are back to standby mode.

### 10. Talk volume adjust

During talking, touch “◀” or “▶” (pic.6) to adjust talk volume. The adjustable range is 0-100. Auto reserve after exit.

## Operation



Pic. 4

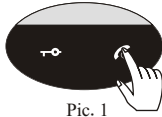

Pic. 1



Pic. 6

**11. Outdoor call reminding**

- When the indoor monitor is under standby, monitor, intercom mode, if the outdoor unit calls in, both the indoor and outdoor unit will sound the ring.
- During the indoor unit talking with door 1, if door 2 calls in, the indoor unit's screen will display “📞” instead of ring.

**12. Same room number alarm (suitable for more indoor units)**

When two indoor units are with the same room number, the unit will sound “DI--DI--DI” , then you need to change the room number and after changing, if the alarm is still in, you need to re-start the unit.

**13. Communication problem (for more indoor units)**

If the unit sound “DI DI” every 3s, it means the problem is between this monitor and main monitor, please check the connection as well as the power connection for the main unit. After solving the problem, touch “🔗” or “🔌” (pic.7) to connect with outdoor unit again, then the alarm will be disappeared automatically. (The alarm will appear if the connection between the sub unit and main unit is failed in 6 times continuously)

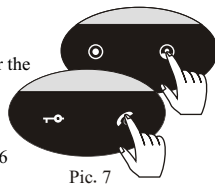

Pic. 7

**14. Navigation buttons' allocating**

When the unit under talking or monitoring mode, “◀” & “▶” is default to adjust the talk volume, “📖” & “📄” to adjust the picture quality, then by touching “⚙️” to switch to image memory mode.



Pic. 6

**15. Buttons' backlight indication**

The backlight will keep on lighting at 6s', if without any operation within 6s', the backlight will be lighted off and you could by touching any button to light on the backlight.



Pic. 7



Pic. 5

If the system can work properly, please don't reset or initialize room number, or it will cause the system improperly working.

### 1. Unit initialization

Under standby mode, insert the needle into the “RESET” hole until the unit sound “DI” , Which means the initialization is successful. After resetting, the system will default to:

Ring for Door 1: DINGDONG ; Ring time: 20S ; “🔇” : Mute (No bother)

“🔕” : Away ; “🔍” : memory review (available for the model with image memory function)

CCTV MODE: 1 ; Aux.service time: 3S;

Home & Guest message: turned off

The recorded data for DIY music, home message and guest message will be deleted.

### 2. Manually setup room number

Main menu → System set → Room number set, after the successfully setup, the screen will display “ROOM SET OK” , but if the two units with the same room number, the unit will sound “DI” to alarm.

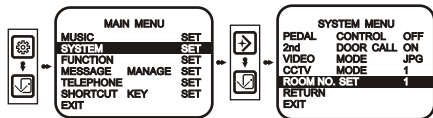

### 3. Automatically setup room number

- a. When the system only have 1 monitor, after connection and call from outdoor, room number will be automatically setup.
- b. When the system have 2 monitors, initialize 2 monitors first, then call from outdoor, after both monitors are successfully ringing, stop the call. Then the room number will automatically setup.
- c. When the system have more than 2 monitors, initialize all indoor monitors, then connect the power of main monitor and monitor 2 you need, call from outdoor, after successfully ringing on two monitors, stop the call. Then connect the power of monitor 3 you need, call from outdoor, after successfully ringing on all monitors , stop the call. Do the same operation for monitor 4.

## Introduction for color Image memory ( W80/PH80)

The unit ( W80/PH80) which with color image memory has the following functions:

### 1. Photo taken

The unit can take the photo with time information, max to 80pcs (W80/PH80 model)

### 2. Review

The users can review the taken photos under monitor or talk mode

### 3. Auto-off

During reviewing, if without any operation within 15s, the review function will be turned off automatically.

### 4. Time information display and edit

When the system under memory mode, the screen will display the time and date information and you can edit the time as well.

### 5. Away management

When the unit is under Away mode, the system will automatically to take the photos of each calling.

## Operation for color Image memory (W80/PH80)

### 1. Auto/manual taken photos

- Under away mode, when outdoor calls in, the unit will take the photo automatically.
- During the talking between outdoor and indoor unit, touch “⚙” & “➔” to take the photo with time information.

### 2. Review / Delete taken photos

Touch “⊕” (screen on) --- “⚙” (till there have time and date display at upper right corner on screen)--- “🖼” to enter into 6 photos reviewing interface, by touching “🖼” to review the photos in full screen, “⏪” / “⏩” to review the last / next one. If want to delete the photo, touch and hold “⏪” for 3s to delete

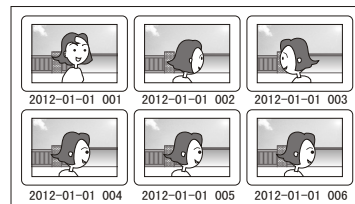

### 3. Time setting / Format image memory

Touch “

“

Set Date / Time: Touch “

Format image memory: Touch “

The unit (W200 / PH200) which with color image memory has the following functions:

### 1. Photo taken / Video recording

The unit could take the photo or record the video for 10s in AVI format to save to SD card

### 2. Review the taken photo / recorded video

The users can review the taken photos or recorded video under monitor or talk mode, and the data could be saved even the power is cut off suddenly.

### 3. Auto-off

During reviewing, if without any operation within 15s, the review function will be turned off automatically.

### 4. Time information display and edit

When the system under memory mode, the screen will display the time and date information and you can edit the time as well.

### 5. Away management

When the unit is under Away mode, the system will automatically to take the photos / recorded video of each calling.



The operation for Auto/manual taken photos & Review and delete taken photos is the same as W80/PH80

### 1. Manual video recording

Touch “⏻” --- “⚙” (till there have time and date display at the upper right corner on screen, touch “⏪” to record the video for 10s in AVI format.

**Remark:**

1. During recording, “📁”, “📷”, “⏪”, “⏩” are invalid, touch “⚙” to stop the recording.

2. For manual recording, the picture and voice could be recorded at the same time under talk mode, if in other modes, could recorded the image only.

### 2. Auto video recording (When the system has more than 1pc indoor unit, only the main unit could record the video)

To turn on the Away function (Main menu---Function set---Away set) and choose the Video mode to AVI format (Main menu---System set---Video mode, suggest to set the ring time to 5S), when visitor calls in, the unit will record the video automatically.

### 3. Review / Delete the recorded video

Touch “⏻” (screen on)--- “⚙” (till there have time and date display at the upper right corner on screen) --- “📁” to the review mode, touch “⏪” / “⏩” to review the photo and when there have “📷” icon display at the upper right corner on screen, to touch “📁” to play the video. If you want to delete the recorded video, touch and hold “⏪” for 3s to delete.

### 4. Time setting / Format image memory and SD card

Touch “⏻” (screen on)--- “⚙” (till there have time and date display at upper right corner on screen) --- “📁” (touch and hold for 3s), to enter into the below interface:

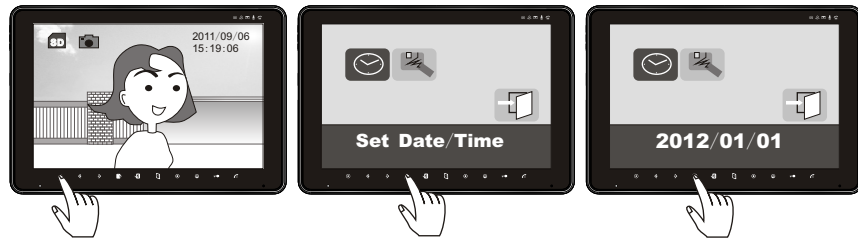

Set Date / Time: Touch “📁” to enter, touch “⏪” / “⏩” to set the value, touch “📁” again to the next item, when setting finished, touch “📁” to exit.

Format image memory and SD card: Touch “⏪” / “⏩” to select and touch “📁” to enter, touch “⏪” / “⏩” to choose “YES” or “NO” to format, then touch “📁” to exit.

**Remark:**

1. Please format the SD card for the first time using.
2. In the process of recording / playing photos or video, the SD card can't be taken out. When cut off the power, the pre set time will be lost in 7 days.
3. If the unit without SD card, the screen will display "NO SD CARD" when enter into the memory mode.
4. If the displayed pictures are abnormal during reviewing the photo or video, please format the SD card and try again.
5. The capacity of 2G SD card: save over 1000pcs photos or record video for 80 minutes and each video is 10s.

**Instruction of voice status:**

1. "DI---DI---DI..." : 2 indoor units with the same room number.
2. "DIDI---DIDI---DIDI..." : communication problem.
3. "DU" : The function is disable.
4. DI for 6 times: telephone line is not connected well.

**Instruction of light indicators:**

1. "⚙️" LED lights on: Away function is turned on.
2. "🏠" LED lights on: The 2<sup>nd</sup> door calls in.
3. "🔇" LED lights on: Mute (No bother) function is turned on.
4. "✉️" LED lights on: The home message function is turned on.
5. "✉️" LED keep flashing: remind you to check the home message.
6. "🎤" LED lights on: recording the message.
7. "🎤" LED lights on: playing the message.
8. "🎤" LED lights on: guest message is being played to visitor.
9. "☎️" LED lights on: telephone function is on working.
10. "☎️" LED keep flashing: the telephone line is not connected well.

## OSD menu operation

The items (Brightness, Contrast, Color, Impact, Color SYS, Language, Scale, Volume & Reset) which show in menu A & menu B could be adjusted in OSD menu.



Menu A

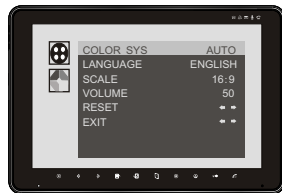

Menu B

Touch “” / “” — “” to enter into OSD menu interface:  
 “” / “” to choose the item, “” / “” to adjust the value  
 From menu A enter into menu B: Choose “Exit” then touch “”

## Troubles shooting guide

Problem	Possible reason	Solution
Totally cannot work	The unit haven't connected power. The unit is under OFF mode.	Check if the power is ON. Refer to OPERATION point “1.ON” .
Outdoor unit cannot call	The connection between indoor and outdoor unit is cut. The main monitor is OFF.	Check the connection between indoor and outdoor unit. Refer to OPERATION point “1.ON”.
Can not monitor outdoor camera	Room number haven't setup. Outdoor camera line fault	Refer SPECIAL FUNCTION point “3. Automatically setup room number” to setup the room number again. Check outdoor camera's connection
Indoor monitor sound “DI DI” at intervals ( more monitors)	The main monitor is OFF. The connection between this monitor and main monitor is cut.	Refer to OPERATION point “1.ON”. Check the connection between this monitor and main monitor
Indoor monitor sound “DI” continuously (more monitors)	There are two monitors have a same room number.	Refer SPECIAL FUNCTION point “2. Manually setup room number” to setup the room number again .
Talk voice normal but have double or abnormal image	Last extension monitor's VD-R switch is in wrong position.	Dial last extension monitor's VD-R switch to ON position and others to OFF.
Talk voice normal but image is dark or twist (more monitors)	More monitors' VD-R switch in ON.	Put last extension monitor's VD-R switch to ON position and others to OFF.
Outdoor camera can not call in, indoor unit can not monitor outdoor and sound “DI DI” at intervals	Main monitor is OFF. There is no main monitor	Refer to OPERATION point “a.ON”.Initialized the monitor, refer to SPECIAL FUNCTION point “3. Automatically setup room number”.
Outdoor can hear indoor, but the voice from outdoor is too small	Talk volume is too small.	Refer to OSD menu operation “talk volume adjust”, adjust the talk volume to the best quality.
When the system only have one monitor, outdoor camera can not calls in and indoor monitor can not monitor/ talk with outdoor	This monitor is not main monitor.	Initialized the monitor, refer SPECIAL FUNCTION to setup the room number to 1.

## Specifications

Item \ Model	SA20C	SA20C-PH	SA20C-W80	SA20C-PH80	SA20C-W200	SA20C-PH200
Screen	10.2" color TFT					
Power supply	AC100-240V ~50HZ/60HZ 15W or DC13.5V /1.5A					
Connection with extension unit	In series					
Talk	Hands-free					
Power consumption	13.5V, 700mA (max.)		13.5V, 850mA (max.)			
CCTV video input	Typical value 1Vp-p(75 ohm)					
Video output	Typical value 1Vp-p(75 ohm)					
Optional ring tone	Chord ring / Dingdong					
Connection wire length and wire requirement	30m	50m	100m	Remark: In order to make sure the best quality, the wire length from outdoor unit to the last extension unit should be less than 100m.		
	RVV4*0.3	RVV4*0.5	RVV4*0.75			
Operation temperature	-10℃ to +55℃					
Optional extension unit	KW-128C, KW-730C, KW-125C, S700C, S701C, S702C, S704C etc.					
Optional outdoor camera	All of KENWEI 4-wired outdoor cameras (Suggest to connect the outdoor panel that the horizontal resolution of lens is 600TV lines)					
Telephone connected mode	Non-polarity, 2-wired					
Telephone decoding mode	FSK or DTMF					
Dialing mode	DTMF					